

WELCOME TO:

Camp   
Firefly

Team 764



# WELCOME TO CAMP FIREFLY!



Hey! Are you looking for a fun, thrilling time out in nature, but hate mosquitos and sleeping on the hard ground? Then come join the adventure at Camp Firefly! Here we have exciting waterfalls, cliffs, and tons of friends waiting for you! We even have a secret or two just waiting to be found and explored. We have attractions for all ages from thrilling jeep tours to beautiful dining under the stars so our “campground” is perfect for any family or group of friends!



One of the primary goals of our theme park is to bring nature to children who might not have as easy access to it and foster a spirit of adventure and discovery in them. Part of this message also includes respecting the environment we all live in, so we do not try to cover up that we are located in a repurposed structure! Our “camp grounds” are located entirely inside of a repurposed mall, but this also means there is no need for sunscreen or bug spray here! Our primary location, in Arlington VA, is ready and waiting for you, the perfect place to escape the city and experience nature. All the planning and resources are available in camp and at our famous “Trading Post” as well, so what are you waiting for? Come on down and visit Camp Firefly today.



**Pricing: 3 & under, Free 4-12, \$15 Adult, \$25 Senior, \$15 Veteran, \$10**



# MALL TRANSFORMATION

In keeping with the theme of nature, the exterior of the abandoned mall in Arlington will be refitted with a cabin like facade. The previous entrances to individual stores will be taken down and used as employee and merchant entrances and the main entrance will be refitted to clearly display the name of the park.

In order to minimize costs and play into the “reclaimed mall” aspect of our park, the main structure of the mall will remain the same with the exception of the creation of the circular domed restaurant attraction. The interior will also remain the same in structure with the exception of the two ride attractions where the two floors will be combined into one large space.

Notably the sky light feature will remain in the main hall to let in natural light, and the retail location “The Trading Post” and the kitchen area from the previous food court will remain in tact, but renovated to match the theme.

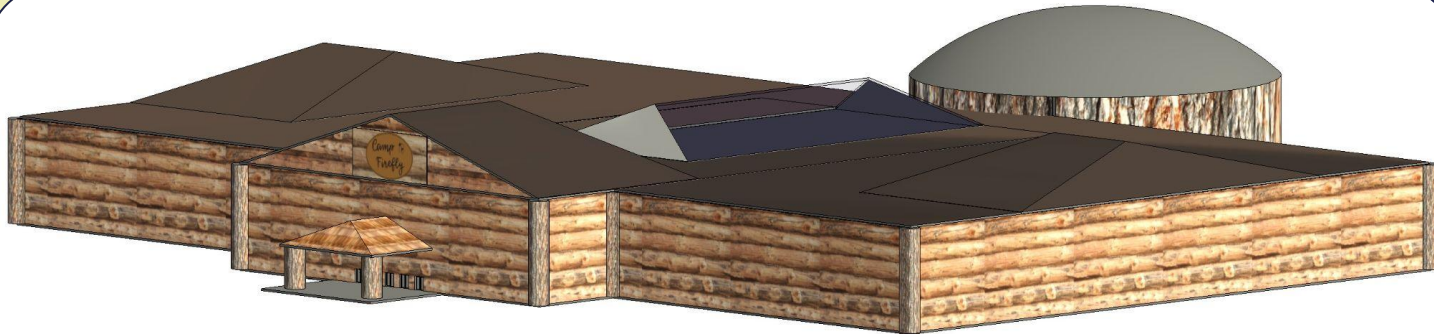

Camp   
Firefly

## Mall Specs:

**1st Floor:** 237,500  
Sq ft

**2nd Floor:** 81,800  
Sq ft

**Floor Height:** 20 ft

**Max Height  
(attractions):** 50 ft

**Max Height (Main  
Hall):** 60 ft

# 1ST FLOOR LAYOUT



The first floor features entrances to all attractions through the main atrium.

Features include tire tracks to “The Trailblazer” and a giant tree that guests walk under to enter “The Trading Post”.

There will also be seating areas and small foam play areas for young children while parents take a break. (not pictured)

## 1ST FLOOR

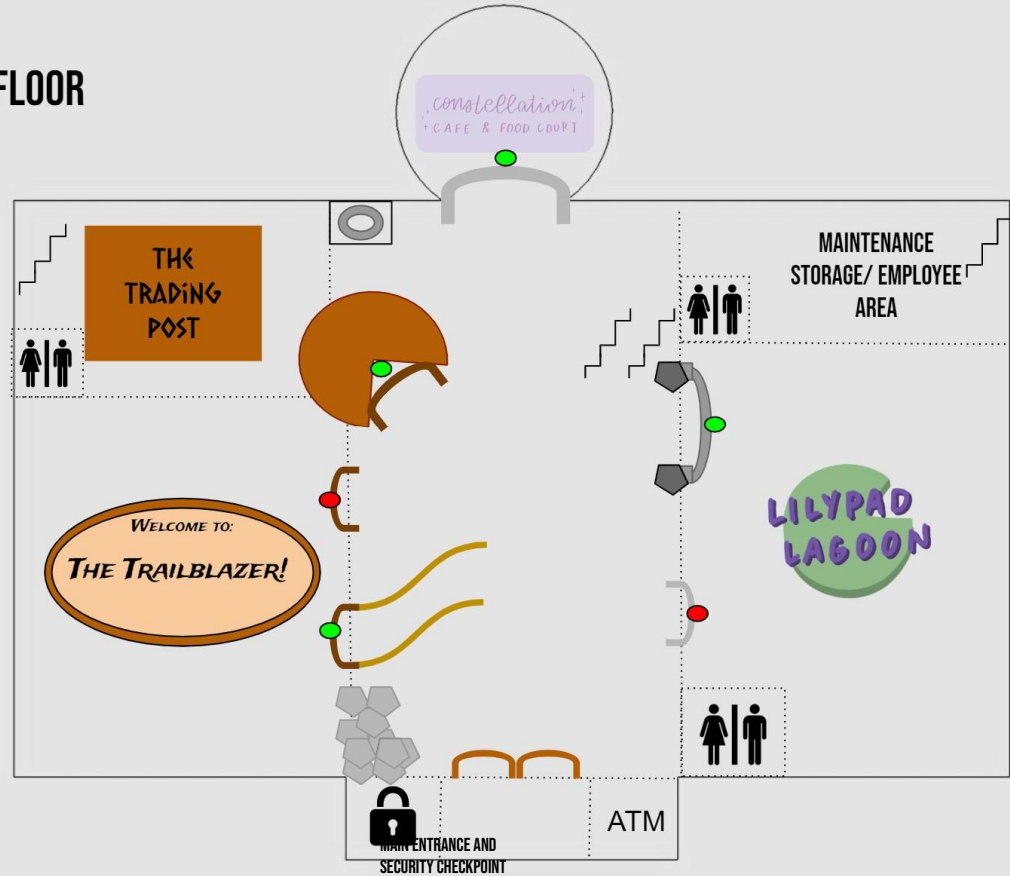

### Key:

- Bathrooms
- Locker Storage
- ATM/ Ticket Sales
- Stairs
- Elevators (2)
- Attraction Entrance
- Attraction Exit



# 2ND FLOOR LAYOUT

The 2nd floor contains entrances to the sit down section of the Constellation Cafe and the Trading Post. It also features a balcony with basic seating, and it overlooks the main atrium.

Above the entrance of the park, there is a simple show stage where “park rangers” give announcements and perform simple skits.

## 2ND FLOOR

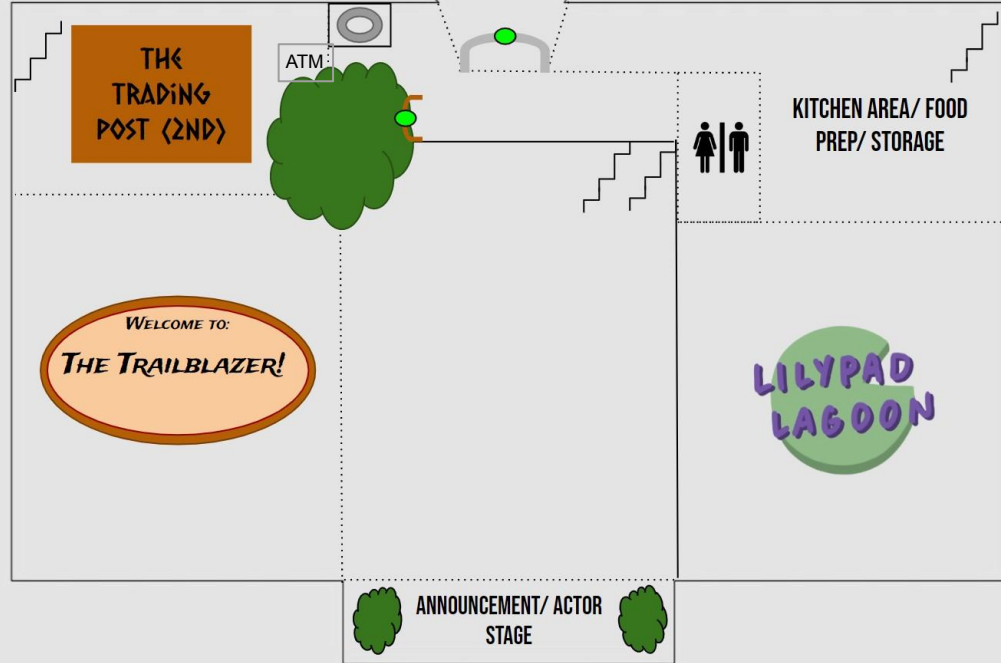

### Key:



Bathrooms



Locker Storage

ATM

ATM/ Ticket Sales



Stairs



Elevators (2)



Attraction Entrance



Attraction Exit

# RIDE 1: THE TRAILBLAZER

Welcome to the Trailblazer! This jeep adventure will take you up the beautiful, but dangerous path of Firefly Mountain. Expect a gorgeous view of the skyline and even a waterfall! Be careful around that old bridge over the falls though...

The Trailblazer is a fast paced thrill ride that utilizes the technology of a mouse trap coaster, and combines it with show elements of a dark ride. This ride is not for the faint of heart, but is fun for every adventurous member of the family.

WELCOME TO:  
***THE TRAILBLAZER!***  
***A JOURNEY AROUND FIREFLY  
MOUNTAIN!***

FIREFLY  
MOUNTAIN



# THE TRAILBLAZER: RIDE SYSTEM



Jeep Ride Vehicle

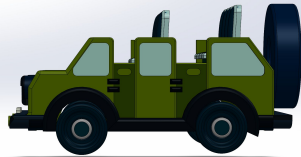

Ride Vehicle  
Side Profile

## Unique Vehicle License Plates

**ROCKY**

**BEAR**

**BLAZER**

**RANGER**

**SCOUT**

**CUB**



This ride system utilizes a pinch wheel drive system to power the ride along the slotted guide rail track and through the tight turns. Pneumatic actuators are utilized to pitch, roll, and yaw the vehicle up to 20 degrees. The ride reaches a max speed of 14 mph.







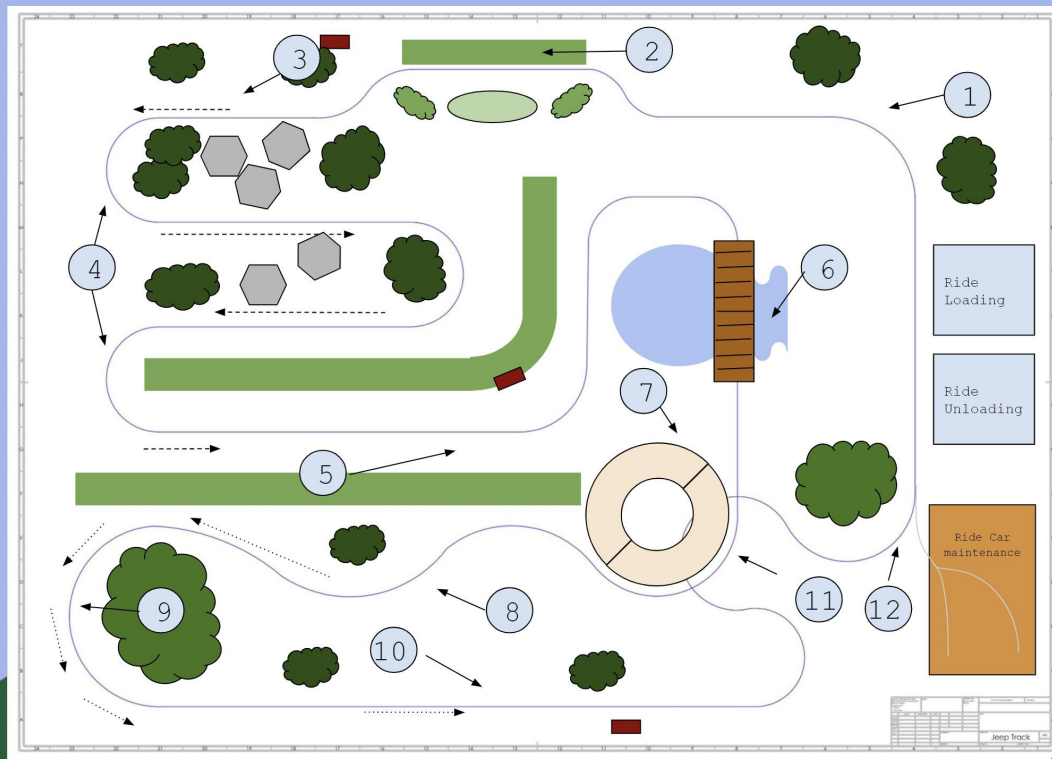

The duration of the ride is 3 minutes. 8 riders are arranged in 2 rows of 4. There are 6 vehicles in use at a time, with 2 docked at load/unload. The hourly capacity is 960 riders/hour.

The height requirement is 4'2". The restraint system for this ride is a lap bar and qualifies as a Class 2 by ASTM Standards.

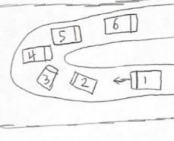
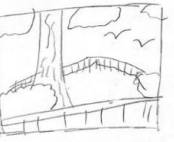
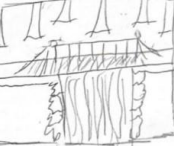
# TRAILBLAZER: RIDE LAYOUT

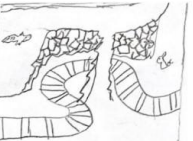

Key: ■ Emergency Exit Points 🌳 Trees/ scenery elements

- |    |  |   |    |  |  |
|----|--|---|----|--|--|
| 1  |     | Intro plays and riders leave camp                             | 2  |    | Ride starts gently through a forest  |
| 3  |   | At the base of the mountain, speed increases                  | 4  |   | Jeep "Drifts" around corners, swinging riders                                      |
| 5  |   | Once at the peak, the jeep slows and overlooks the mountain   | 6  |   | At a waterfall crossing, the bridge shakes and "breaks"                            |
| 7  |   | Recrossing the bridge is not an option, a new path is "found" | 8  |   | A rough and bumpy dirt path is taken   |
| 9  |   | A giant spiral whisks riders down around a tree               | 10 |   | Safely off the mountain, the jeep slows  |
| 11 |  | A quick loop under the mountain get riders back on track      | 12 |  | Camp sign and cabins come in view as ride ends (ride maintenance has cabin facade) |



# RIDE 2: LILY PAD LAGOON

Welcome to Lily Pad Lagoon, a more gentle ride that provides a relaxing experience, but is full of so many wonders to look at that it will take a few rides to find them all! Our senior park rangers only recently found this river on the campgrounds, so who knows, with your help we might discover a new secret the forest is hiding!

This is a water ride with free floating rafts being guided by gentle currents and guide wheels, so just sit back in your giant lily pad and relax! This ride also includes our crystal flashlights, which can activate extra features around the forest, so be on the lookout for crystals!



LILYPAD  
LAGOON



The crystal flash lights are attached to the side of every seat and can be used to shine on the surrounding forest. Don't worry about a harsh glow affecting the mood either, the special light inside the flashlights can only be seen after it hits a crystal!

# LILY PAD LAGOON: RIDE SYSTEM

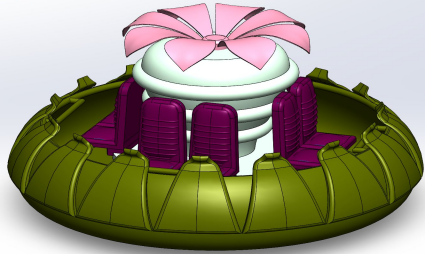

Lily Pad Ride Vehicles

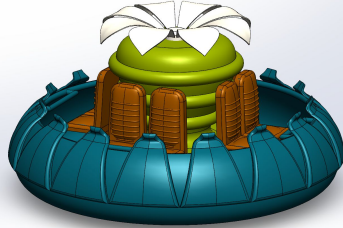
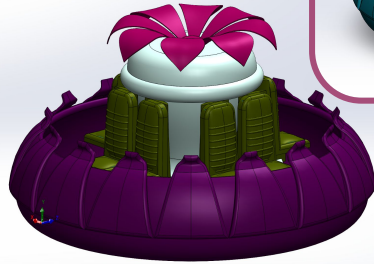

This ride system utilizes water current and guidance wheels to move the rafts along the path. The ride reaches a max speed of 8 mph and has no inclines.

The duration of the ride is 4 minutes. 8 riders are arranged facing outward in a circle around the raft. There are 12 vehicles in use at a time arranged in 4 platoons of 3 rafts, with 1 loading/unloading. The hourly capacity is 1,440 riders/hour.

There's no need to worry about getting wet, this is a dry ride, but in case you do get a tiny splash we have a backup plan. As we are indoors, being wet is not fun for you or our wonderful cleaning staff, so we have full body dryers free and available for use at the end of the ride!

## Cave Waterfall

3

All children under 40" must be accompanied by an adult.

A lap belt system utilizing a traditional belt buckle is used for this ride and qualifies as Class 2 by ASTM standards.

# LILYPAD LAGOON: RIDE LAYOUT

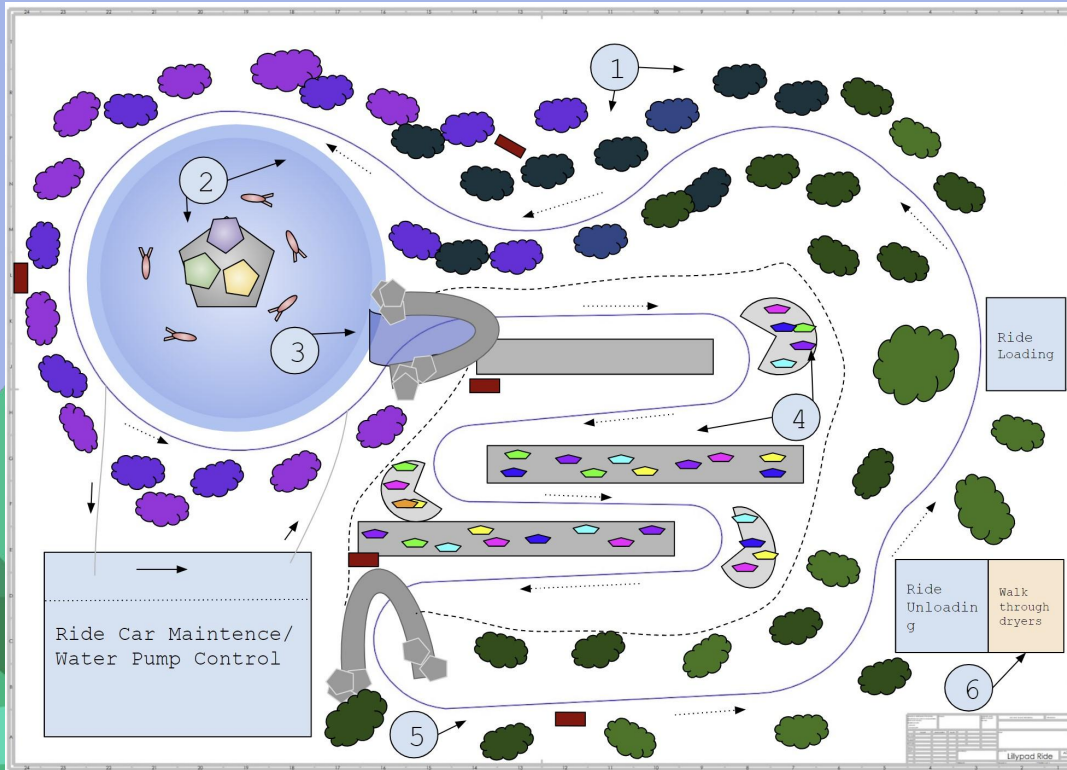

1. The ride begins, the forest transitions from bright and normal, to a more mystical feel
2. Lagoon is reached, in the middle is a rock with animal animatronics (turtles, fish, birds)
3. The waterfall parts and riders enter the cave
4. Inside crystals appear, with larger show scenes on turns
5. Riders exit the cave and return to a normal forest
6. After exiting the ride, free full body dryers are available

\*In case of a ride breakdown, staff members follow paths near exit points and can dock rafts near them to safely unload riders

**Key:** ■ Emergency Exit Points\* 🌳 Trees/ scenery elements

# RETAIL: THE TRADING POST

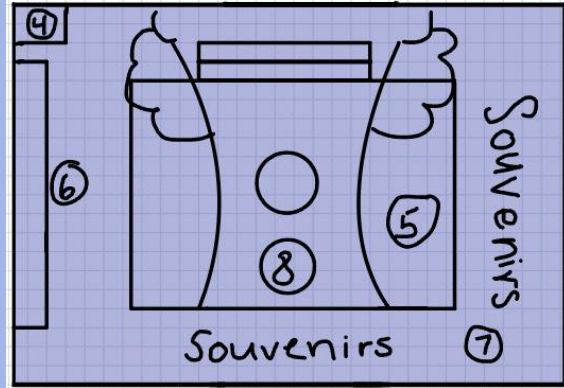
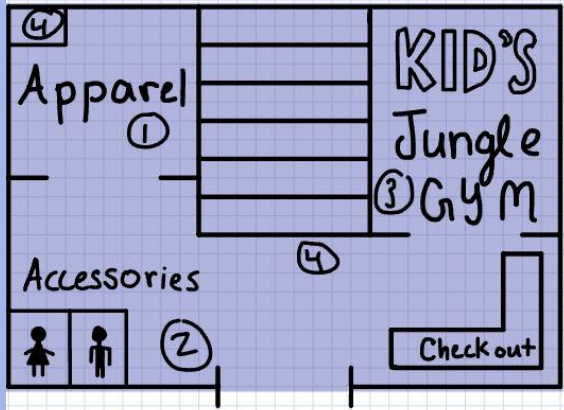

1. Apparel: Short sleeved shirt, Long sleeved shirt, sweatshirt.
2. Accessories: Backpacks, Water bottles, pennant flags, jewelry.
3. Kid Jungle Gym: A place for young kids to run around and climb equipment.
4. Stairs: Leads up to the second floor. Elevator is available as well.
5. The second floor is a balcony that overlooks the first floor.
6. A flat screen that toggles between a video of how Camp Firefly was founded and an interactive video for children
7. Souvenirs: Custom Flashlights, trail mix, granola bars.
8. A large aesthetic tree that the stairs pass through.

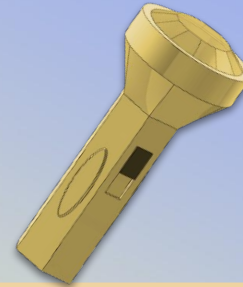

## **Key Item: Custom Flashlight**

These flashlights can be personalized with names or symbols, and mirror the ones used in the Lily Pad Lagoon.

## THE TRADING POST

# RETAIL: ADDITIONAL PRODUCTS



Offered in: XS, S, M,  
L, XL, XXL  
Short Sleeve: \$15  
Long Sleeve: \$25  
Sweatshirt: \$30



Pennant Flags: \$15

Water Bottle: \$20



Gourmet Trail Mix and Granola Bars

Single: \$2 six pack: \$10

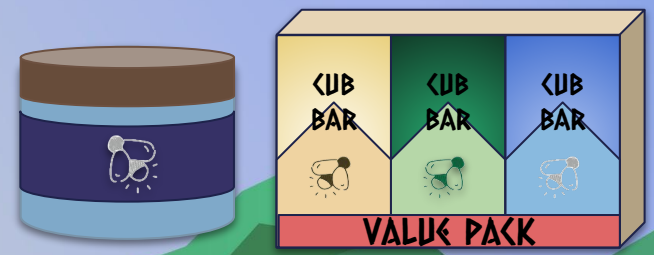

# DINING: CONSTELLATION CAFE & FOOD COURT



Eat dinner under the stars! This restaurant features a planetarium-style ceiling that can project images and videos of the sky. Ever so often special events occur such as meteor showers, and constellations begin to appear.

- Bottom Level: Fast food/food court, can buy pre-made food or food kits and go sit in the lower level to heat it up at fire pits, or just eat!
- Upper Level: Sit-down dining, Korean BBQ style with cooking grills in front of you to cook it yourself. Up higher to maintain a more mellow atmosphere and feel closer to the stars.



constellation  
+ CAFE & FOOD COURT

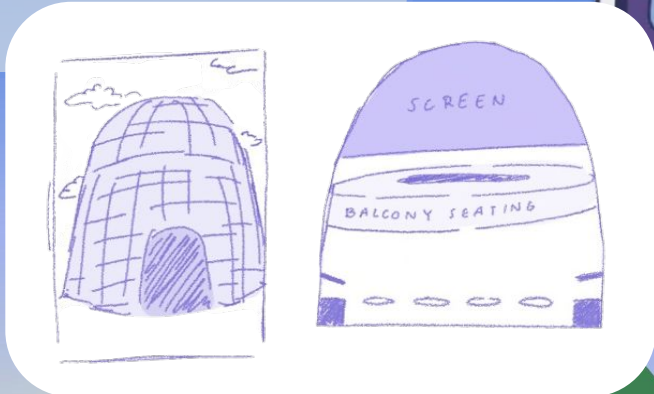

# DINING: CONSTELLATION CAFE & FOOD COURT

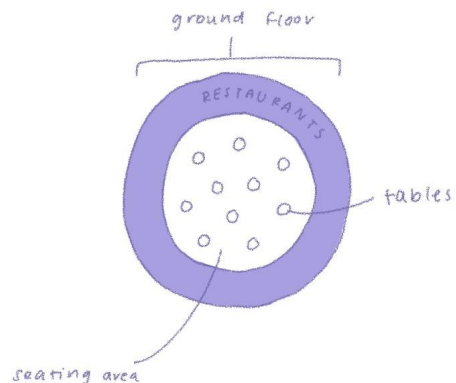

**Lower Level:**  
food court  
seating, rounded  
booths



**Upper level:**  
sit down, Korean  
BBQ style grill



Signature Dish: Campfire Kebabs

## THE CAMPFIRE GRILL



ENJOY A MEAL UNDER THE STARS

### APPETIZERS

**Mexican Grilled Corn**  
Three pieces of grilled corn topped with cheese and spicy seasonings. **\$ 7.99**

**Cozy Pigs In A Blanket**  
A platter of mini hot dogs wrapped in fluffy pastry dough. **\$ 9.99**

**Garden Salad**  
A salad with blue cheese, bacon bits, arugula, and balsamic vinegar. **\$ 8.99**

### ENTREES

**Barbeque Set**  
Choose a marinated pork, beef, chicken, or veggie set to cook on the grill in front of you! **\$ 35.99**

★ **Campfire Kebabs**  
4 lamb skewers with bell peppers, onions, mushrooms, and potatoes. **\$ 25.99**

**Veggie Burger**  
A choice of chickpea or black bean burger with sweet potato fries. **\$ 22.99**

### DESSERTS

**Trail Mix Cookies**  
Cookies with chocolate chips, pretzels, cranberries, almonds, and potato chips. **\$ 10.99**

**S'mores Kit**  
Get your kit of graham crackers, chocolate, and marshmallows. **\$ 15.99**

**Peanut Butter & Jelly Brownies**  
Soft, gooey brownie with peanut butter and jelly swirls. **\$ 12.99**

### DRINKS

**Hot Chocolate**  
A warm mug of hot chocolate topped with marshmallows, whipped cream, and chocolate syrup. **\$ 4.99**

**Iced Tea**  
A refreshing glass of iced lemon tea. **\$ 2.99**

**Fountain Drink**  
Your choice of any fountain drink/soda. **\$ 3.99**

SIGNATURE ITEM - ★

**FOSTER ADVENTURE, EXPLORE NATURE, AND HAVE FUN!**

# Camp Firefly

Thank you for considering our park for your next  
family adventure!